

34 PENJURU LANE

FOR LEASE - B2 WAREHOUSE & LOGISTICS



Located in the south western part of Singapore, 34 Penjuru Lane is a 5-storey warehouse with ancillary offices. It is easily accessible via the Ayer Rajah Expressway and in close proximity to Jurong Fishery Port. With its high number of loading bays, it is ideal for logistics and 3rd party logistics providers.



ACCESSIBILITY

- 10 mins drive to Jurong East MRT and 8 mins drive to Jurong Port
- 2 mins walk to bus stop

BUILDING SPECIFICATIONS

Unit Size

- Ranges from 4,000 - 95,000 sf

Lifts

- 2 Passenger lifts (1,000 kg)
- 5 Goods lifts (5,000 kg)

Unit Electrical Provision

- 150 to 200 amps 3 phase

Floor Loading

- 1st storey warehouse - 20.0 kN/m²
- 2nd storey ancillary office - 5.0 kN/m²
- 3rd - 5th storey warehouse - 15.0 kN/m²

Loading/Unloading

- 31 loading/unloading bays with dock levellers

Security

- CCTV cameras complete with digital video recorder
- 24hr security surveillance

Ceiling Height

- 1st - 3rd storey - 8.7 m
- 2nd storey ancillary office - 3.5 m
- 3rd - 5th storey - 6.5 m

Car Parking

- 9 lots

Amenities Around

- Eateries nearby

Signage

- Signage rights available to selected tenants, subject to payment of license fee

TYPICAL FLOOR PLAN

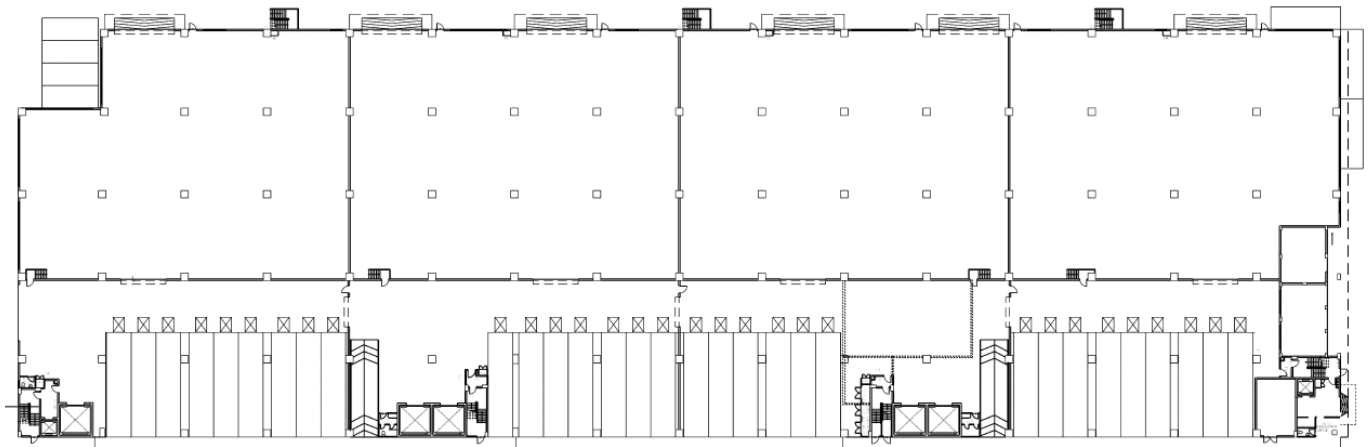

CONTACT US

+65 6580 7760

leasing@sabana.com.sg